

MSC VAULT RELOCATION TO IMPACT WORLD WAY, MAY 7-31st, 12AM – 8AM, M-F

Midfield Satellite Concourse (MSC) construction work requires the installation of two electrical vaults under World Way outer lanes #3 through #5, between Terminal 3 and TBIT. The lanes will be closed May 7th through 31st, Monday to Friday from 12AM to 8AM. Commercial vehicle curb within the work zone will be closed. Detour signs will be placed to direct passengers to the next available shuttle stop. Some crosswalks from terminals to commercial vehicle curbs will be closed.

Outer lanes #1 and #2 and the inner lanes will be available most of the all times. Outer lane #2 will close intermittently as needed. Traffic will be directed to these available lanes. Taxi and Share-Ride Van zones will be available at all times. Pedestrian crosswalks from terminals to parking structures will be open. Access to Parking Structure 3 will also be maintained at all times. See diagram.

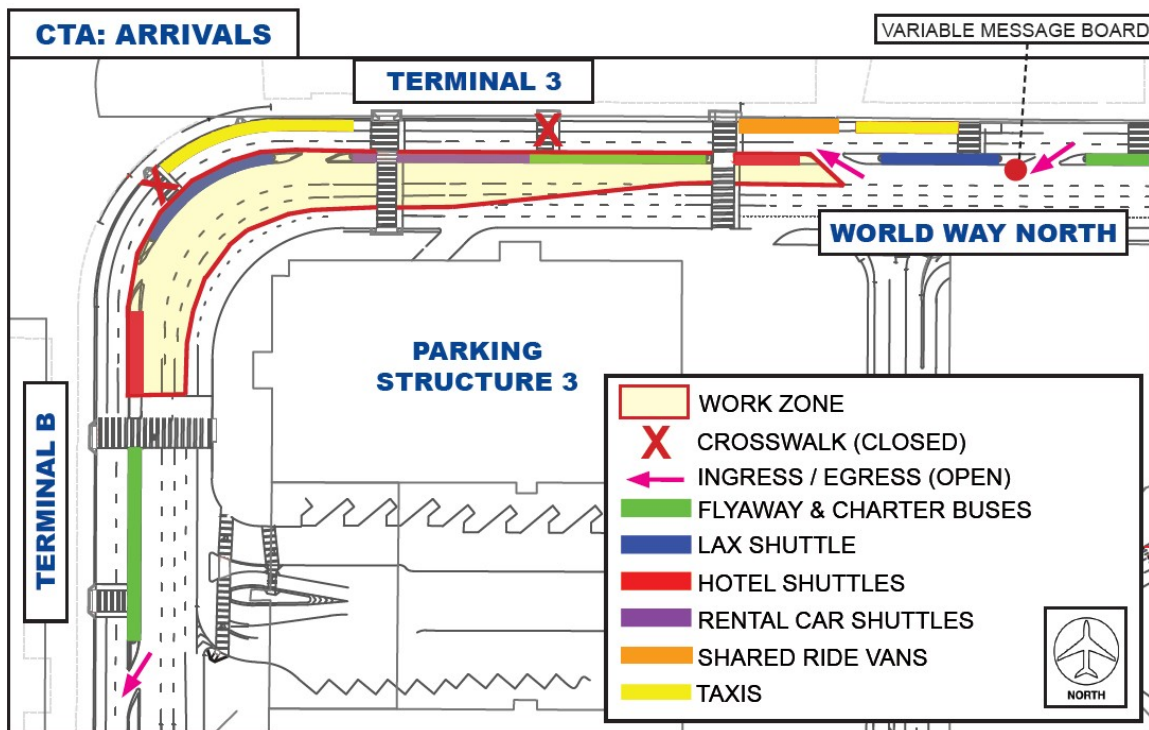

For questions or comments regarding this advisory please contact Landside Operations Manager, Richard Chong rchong@lawa.org

Issue Date: May 4, 2018

Subject: MSC Vault Relocation on World Way

*The LAX Operations Advisory will be posted on LAWA's Airport Operations web site. Click [here](#).

