



LAX
Los Angeles World Airports

LAX Airport Operations

LAX Operations Advisory

Bulletin No: 2019-16

Vehicle Service Road E Traffic Detour – Service Road Repaving

LAWA Facilities Maintenance and Utility Group will repave Vehicle Service Road E between Taxiway AA and Taxilane E14 starting on September 11, 2019 from 0001-0700L and September 12, 2019 from 0001-1000L. Service road traffic will be detoured around the closure area and Post 15 will be closed during the closure hours. Please observe all traffic signage and drive with caution while operating in this area.

For questions or comments regarding this advisory please contact Airside Manager, Jeff Mort, Jmort@lawa.org.

Issue Date: 9/5/2019

Subject: Vehicle Service Road E Traffic Detour – Service Road Repaving

*The LAX Operations Advisory will be posted on LAWA's Airport Operations web site and can be retrieved at <http://www.lawa.org/airops.aspx>



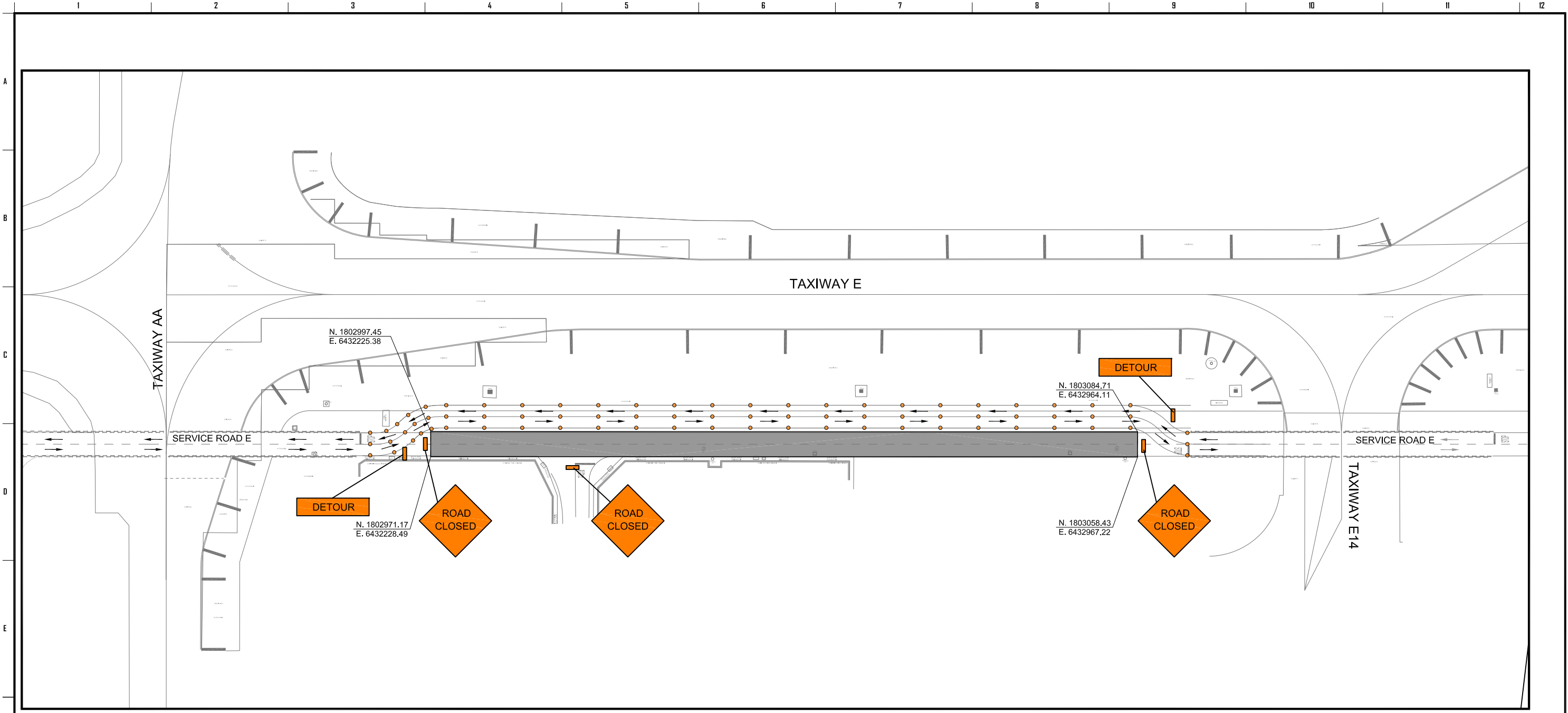

SCOPE OF WORK:

- MILL AND OVERLAY 3-INCH OF AC PAVEMENT
- RE-STRIPE PAVEMENT MARKINGS PER PAVEMENT MARKING PLAN
- PROTECT ALL EXISTING UTILITIES SUCH AS DRAINAGE, POWER MANHOLE, ETC., DURING CONSTRUCTION

AREA:
20,000 SQ FT ±

**PAVEMENT REHABILITATION
TRAFFIC CONTROL PLAN**

SCALE: 1/4"=1'-0"



TRAFFIC CONTROL NOTES:

- BOTH LANE TO BE CLOSED FOR CONSTRUCTION.
- TRAFFIC TO BE DETOURED PER PLAN

LEGEND:

- MILL AND OVERLAY 3-INCH OF AC PAVEMENT
- DIRECTION OF TRAFFIC DETOUR
- TRAFFIC DELINEATORS TO BE PLACED AT 40 FEET SPACING
- SIGN PER PLAN

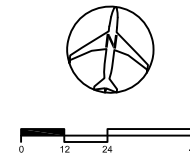

<i>Los Angeles World Airports</i>			
SERVICE ROAD E - PAVEMENT REHABILITATION B/W TWY AA & TWY E14			
PAVEMENT REHABILITATION AND TRAFFIC CONTROL			
LOS ANGELES INTERNATIONAL AIRPORT			
SUBMITTED BY		APPROVED BY	
ASST. CHIEF AIRPORTS ENGINEER		CHIEF AIRPORTS ENGINEER	
DRAWN	CHECKED	PLAN SET NUMBER	SHEET
RPTORRALBA	GNAGY	OF	C-1
SCALE	DATE	DWG NO.	
AS SHOWN	08.23.2019		
GRID LOCATIONS	FILE NAME	20190535	
TO	20190535-C1		

C:\14491 08/29/2019