

# CONSTRUCTION HOT TOPICS

## #1 LANE & SIDEWALK RESTRICTIONS: WB CENTURY BLVD MAY 31 - JUNE 3

TO FACILITATE WORK FOR THE APM PROJECT, WESTBOUND LANES ON CENTURY BOULEVARD NEAR AVION DRIVE WILL BE RESTRICTED FRI., MAY 31 AT 10PM THROUGH MON., JUNE 3 AT 10PM. THE SIDEWALK ALONG WESTBOUND CENTURY BOULEVARD AT THE INTERSECTION OF JETWAY BOULEVARD WILL BE CLOSED FRI., MAY 31 AT 10PM THROUGH SUN., JUNE 2 AT 2AM

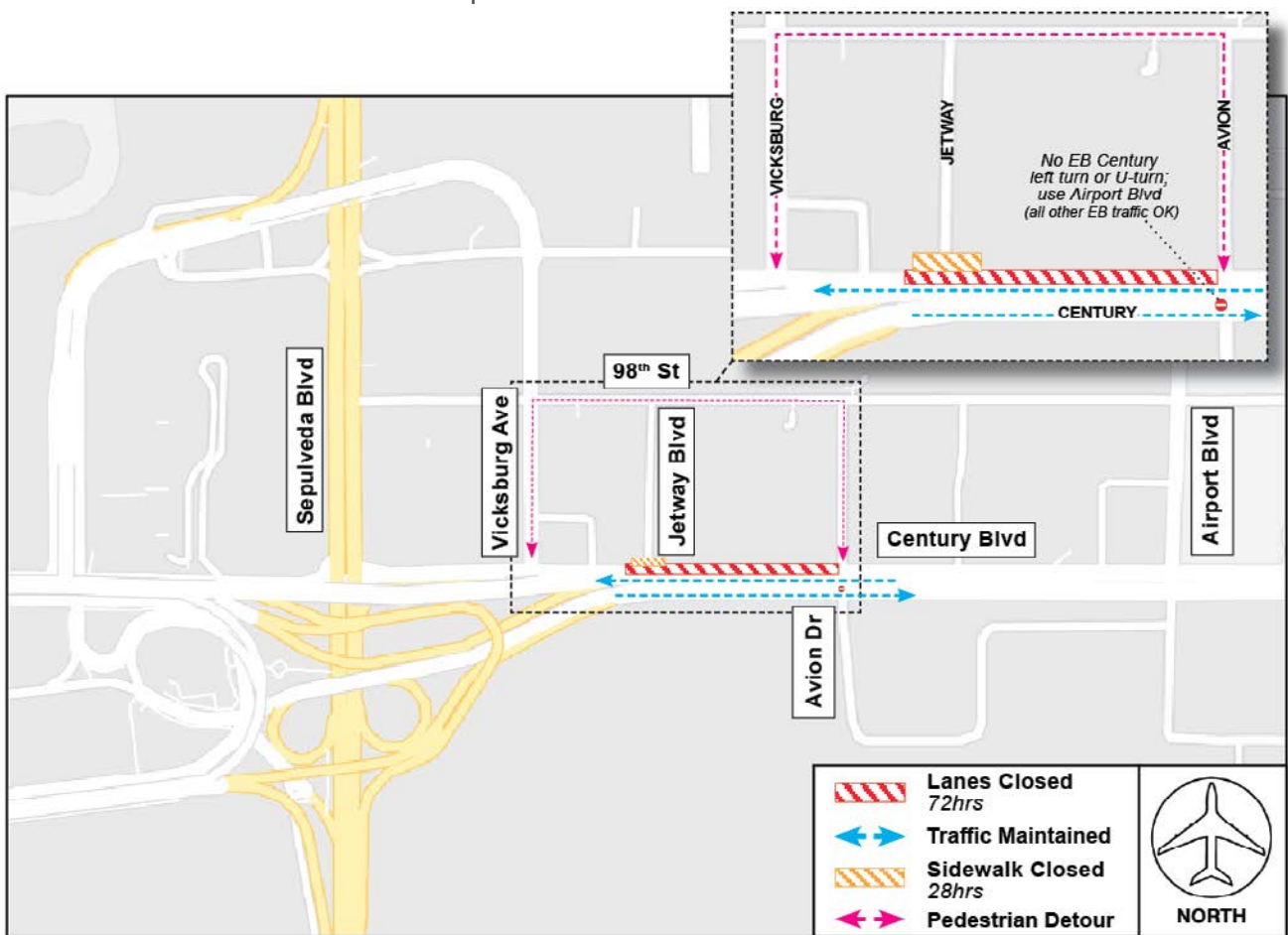

### PLEASE NOTE:

Vehicular and pedestrian access will be maintained at all times, including access to and from LAX as well as access to local businesses and driveways, with detours, signage and flaggers in place.

LAX Construction Hotline: 310-649-5292 LAXConstructionHotline@LAWA.org



flyLAX.com

@flyLAXairport

LAInternationalAirport



# CONSTRUCTION HOT TOPICS

## #2 TERMINAL 2 ARRIVALS LEVEL CURBSIDE BARRICADE REMOVAL: JUNE 2024

AS PART OF THE DELTA SKY WAY PROGRAM AND TERMINAL 2 MODERNIZATION, CURBSIDE BARRICADES AND A TEMPORARY PEDESTRIAN WALKWAY HAVE BEEN IN PLACE ON THE ARRIVALS LEVEL ROADWAY INNER LANE SINCE MAY 2022. STARTING THIS WEEK AND THROUGHOUT JUNE, WORK WILL BE PERFORMED TO REMOVE THESE TEMPORARY CONDITIONS AND RESTORE THE ROADWAY.



### PLEASE NOTE:

Vehicular and pedestrian access and path of travel will be maintained at all times. Work is scheduled to be complete in early July 2024; watch Construction Hot Topics for updates.

 LAX Construction Hotline: 310-649-5292  LAXConstructionHotline@LAWA.org

**LAX**

flyLAX.com

 @flyLAXairport

 LAInternationalAirport

**CALM**  
Coordination and Logistics Management

# CONSTRUCTION HOT TOPICS

## #3 SURFACE LOT 7: RE-OPENED FOR LAWA PERMIT PARKING ONLY

SURFACE LOT 7 (TO THE EAST OF PARKING STRUCTURE 7) HAS BEEN CLOSED SINCE 2020 FOR CONSTRUCTION ACTIVITIES RELATED TO THE AUTOMATED PEOPLE MOVER AND ROADWAY & UTILITY ENABLING PROJECTS. THE LOT HAS BEEN RESTORED AND RE-OPENED FOR LAWA EMPLOYEE PARKING BY PERMIT ONLY. THIS LOT IS NOT OPEN TO PASSENGERS OR OTHERS WITHOUT THE APPROPRIATE PERMIT.



### PLEASE NOTE:

Vehicles parked in Surface Lot 7 without the appropriate hangtag will be cited and towed.

 LAX Construction Hotline: 310-649-5292  LAXConstructionHotline@LAWA.org

**LAX**

flyLAX.com

 @flyLAXairport

 LAInternationalAirport

**CALM**  
Coordination and Logistics Management



# CONSTRUCTION HOT TOPICS



## #4 MAY 2024: 24/7 CTA LANE RESTRICTIONS

THE MAP BELOW IS A COLLECTIVE SNAPSHOT OF ALL SCHEDULED 24/7 LANE RESTRICTIONS FOR CTA DEPARTURES AND ARRIVALS LEVEL ROADWAYS FOR THE MONTH OF MAY 2024.

### PLEASE NOTE:

This map only reflects 24/7 continuous lane closures in the CTA; other nightly lane closures / sidewalk restrictions may be in place to facilitate construction activities

### ACCESS MAINTAINED:

Traffic around the Central Terminal Area will be maintained at all times, as well as access to passenger pick-up and drop-off

### PLAN AHEAD:

Motorists should plan ahead for potential delays

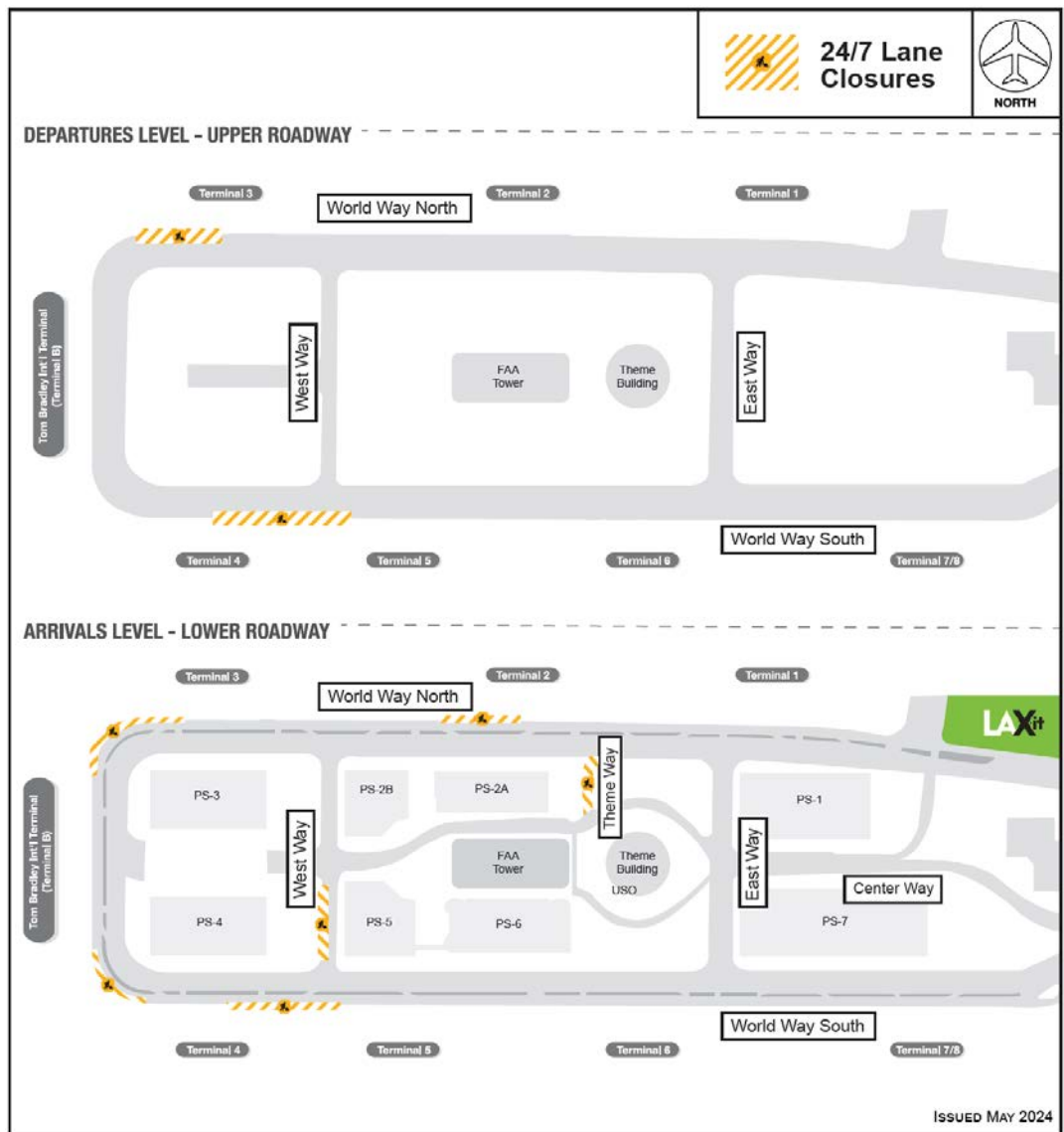

ISSUED MAY 2024

LAX Construction Hotline: 310-649-5292 | LAXConstructionHotline@LAWA.org



flyLAX.com

@flyLAXairport

LAInternationalAirport

