

# CONSTRUCTION HOT TOPICS

## #1 CENTURY BLVD LANE CLOSURES MAY 18 - 19, 2024

TO FACILITATE WORK FOR THE APM PROJECT, AN OVERNIGHT CLOSURE OF UP TO TWO EASTBOUND LANES ON CENTURY BLVD BETWEEN THE LAX EXIT RAMP AND AVION DR IS SCHEDULED FOR SAT., MAY 18 AT 7PM THROUGH SUN., MAY 19 AT 9AM. STARTING SATURDAY NIGHT AT 10PM THROUGH SUNDAY MORNING AT 9AM, A PORTION OF ONE WESTBOUND LANE ON CENTURY BLVD WEST OF AVION DR WILL ALSO BE CLOSED.

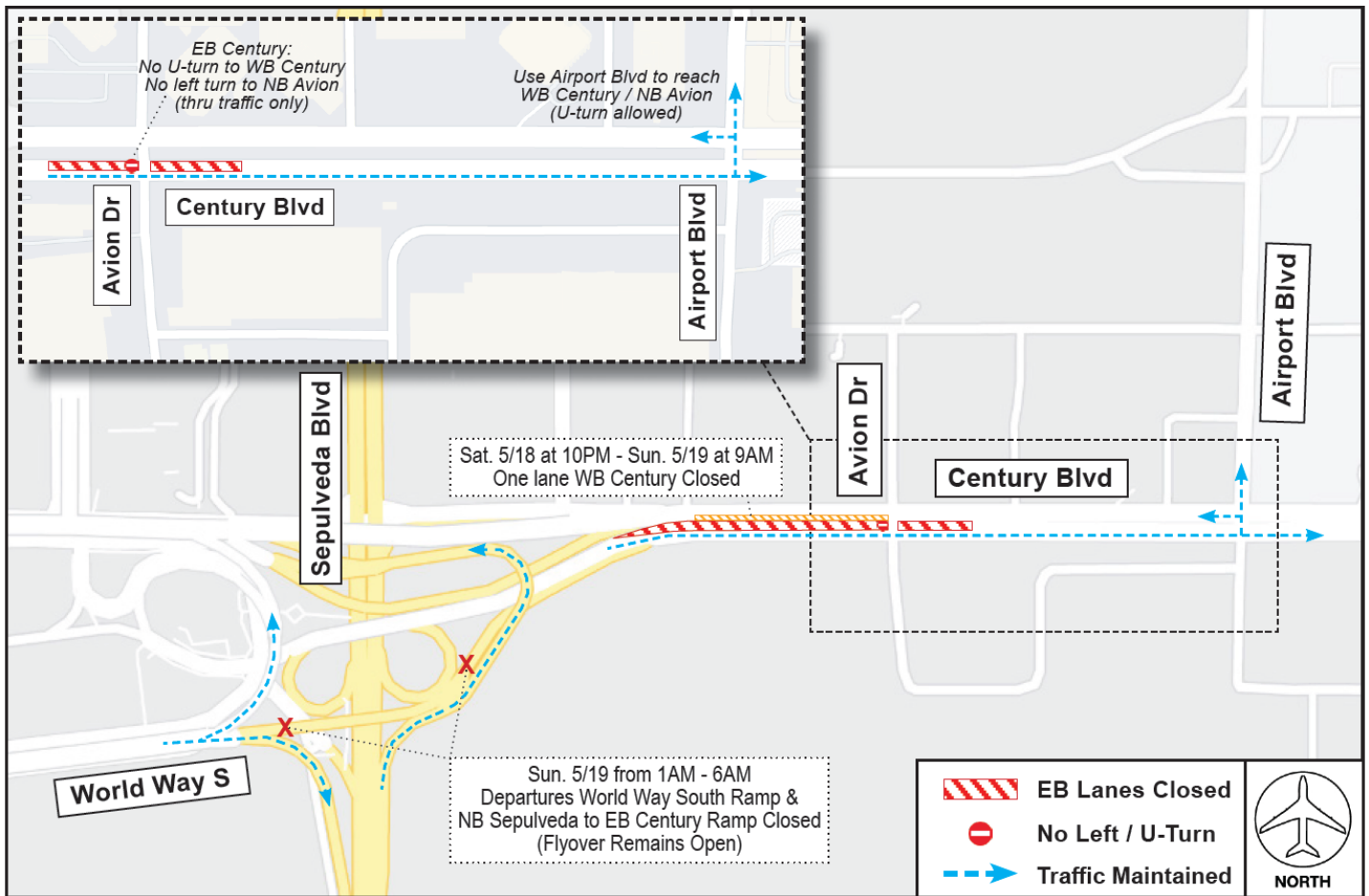

### PLEASE NOTE:

Through traffic in both directions, including access to and from LAX, will be maintained at all times.

LAX Construction Hotline: 310-649-5292 LAXConstructionHotline@LAWA.org



flyLAX.com

@flyLAXairport

LAInternationalAirport



# CONSTRUCTION HOT TOPICS

## #2 TERMINAL 6 AIRLINE GATES RE-OPENING

THE FOLLOWING ARE SCHEDULED DATES FOR AIRLINE GATES RE-OPENING IN TERMINAL 6 IN APRIL & MAY 2024:

GATE 61: MAY 13 (CLOSED AUGUST 2021)

GATE 65B: MAY 13 (CLOSED JUNE 2023)

### PLEASE NOTE:

Airline gate closures are in place to facilitate various construction activities for the Alaska Airlines Terminal 6 Redevelopment Program. Passenger holdrooms and seating areas remain available throughout the terminal.

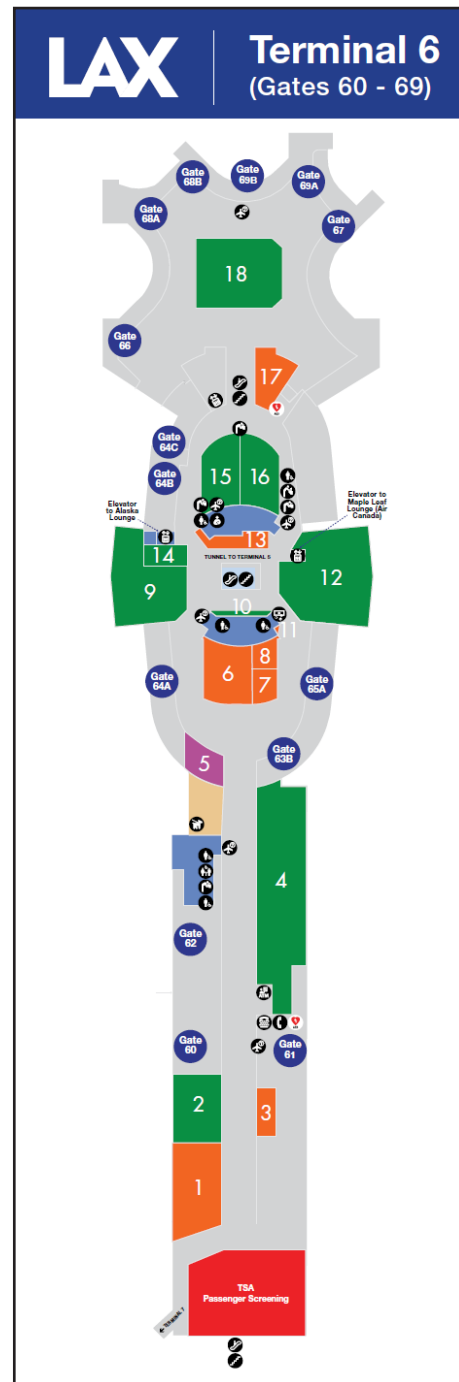

LAX Construction Hotline: 310-649-5292 | LAXConstructionHotline@LAWA.org



flyLAX.com

@flyLAXairport

LAInternationalAirport



# CONSTRUCTION HOT TOPICS

## #3

### RESCHEDULED RAMP & LANE RESTRICTIONS: I-405 AND LA CIENEGA BLVD

TO BE RESCHEDULED:

WORK FOR THE ROADWAY AND UTILITY ENABLING PROJECT SCHEDULED TO IMPACT SOUTHBOUND I-405 RAMPS AT CENTURY BOULEVARD AND A PORTION OF LA CIENEGA BOULEVARD WAS NOT ABLE TO OCCUR MAY 3 - 6 AND WILL BE RESCHEDULED FOR A FUTURE WEEKEND.

WATCH CONSTRUCTION HOT TOPICS FOR MORE INFORMATION ON THIS AND OTHER ROADWAY CLOSURES.

#### PLEASE NOTE:

When work is rescheduled, access to local businesses will be maintained at all times. Detour signage will be posted.

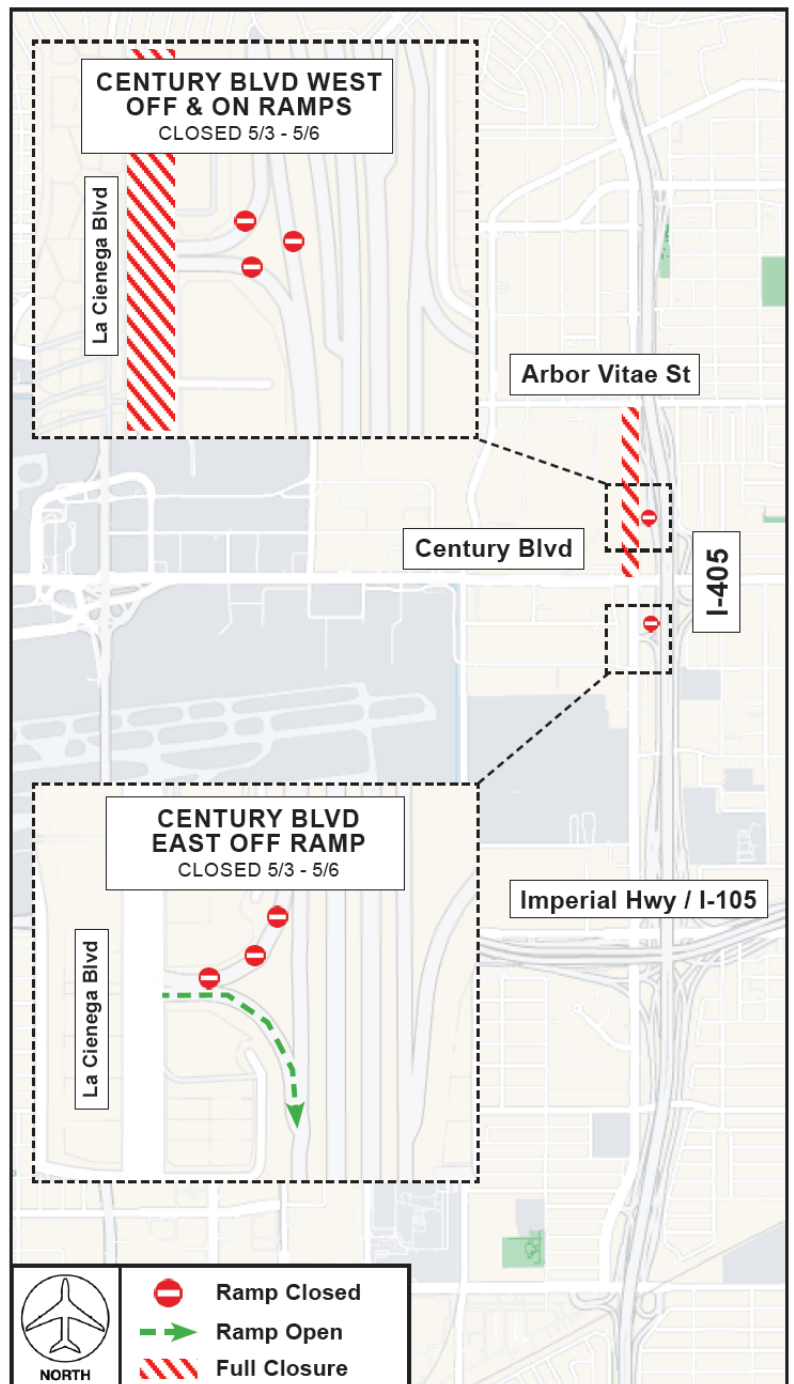

LAX Construction Hotline: 310-649-5292 LAXConstructionHotline@LAWA.org



flyLAX.com

@flyLAXairport

LAInternationalAirport



# CONSTRUCTION HOT TOPICS



## #4 MAY 2024: CTA LANE RESTRICTIONS

THE MAP BELOW IS A COLLECTIVE SNAPSHOT OF ALL SCHEDULED 24/7 LANE RESTRICTIONS FOR CTA DEPARTURES AND ARRIVALS LEVEL ROADWAYS FOR THE MONTH OF MAY 2024.

### PLEASE NOTE:

This map only reflects 24/7 continuous lane closures in the CTA; other nightly lane closures / sidewalk restrictions may be in place to facilitate construction activities

### ACCESS MAINTAINED:

Traffic around the Central Terminal Area will be maintained at all times, as well as access to passenger pick-up and drop-off

### PLAN AHEAD:

Motorists should plan ahead for potential delays

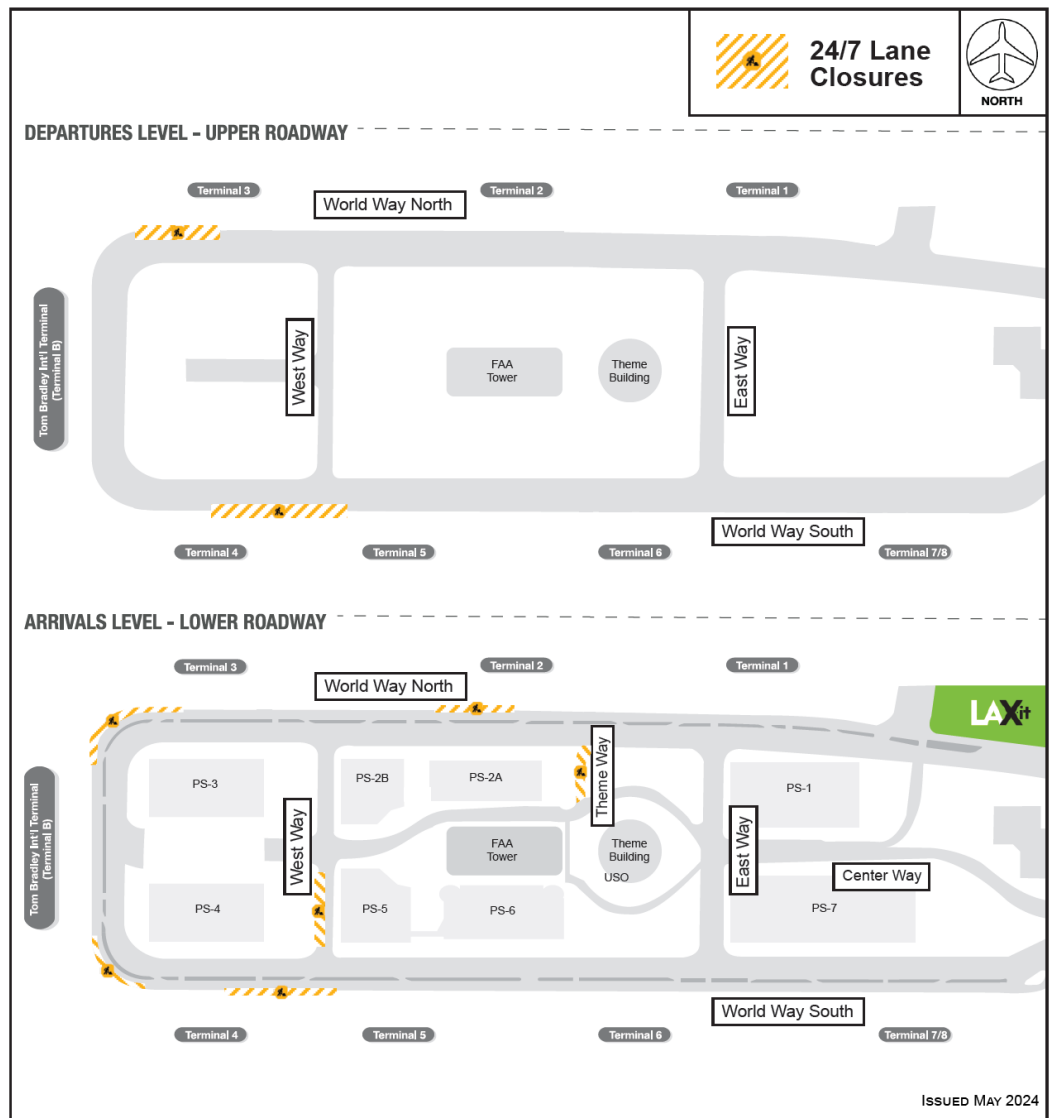

LAX Construction Hotline: 310-649-5292 | LAXConstructionHotline@LAWA.org



flyLAX.com

@flyLAXairport

LAInternationalAirport

